

LANTANA LED

EDGE ASYMMETRIC LINEAR

SPECIFICATION



Edge Asymmetric Linear featuring a small profile is engineered for targeted, directional lighting—ideal for walls, displays, and specialized applications requiring focused illumination.



Efficacy Up to: 164.17 Lm/W

Total Output: 14,939 Lumens

Max Watt: 91

CRI: 80, 90

CCT: 2700K-6500K

UGR: 23 4H/8H

Lifetime: TM 21 L90>71,000

Power Type:

- Class 2 Integral Line-Voltage 120/277V
- Onboard Emergency Battery Backup
- Remote Distributed Low Voltage
- Power over Ethernet

Ambient Operating Temp:

- -20°C to 55°C Integral
- 0°C to 50°C Integral Emergency
- -30°C to 70°C Remote/PoE

Mounting:

- Suspended
- Unistrut (w/wo clip & bracket)
- Surface
- Custom Angle Bracket

Warranty: 5-Year, upgradeable to 10-Year with or without driver replacements included

Additional Features

- High Output Driver
- Replaceable Driver
- 0-10V Dimming Down to 1%
- Focused Directional Light
- Accommodates Multiple Installation Types
- Withstands High Heat Environments
- Small Profile Fits Tight Spaces
- Available in White or Black

Certifications & Standards

- UL 924: Emergency
- UL 1598: Luminaires
- UL 2108: Low-Voltage
- UL Certified for Elevated Ambient Operating Temperatures
- IDCA Certified
- TAA

Applications

- Interior Environments
- Education
- Commercial Office
- Hospitality
- Retail
- Data Centers
- Hot Aisle Containment
- Suitable for Damp Locations

Environmental:

- 100% Recycled Extruded Aluminum
- Recyclable Acrylic
- Title 24 Compliant
- EPD Smart Certified
- End of Life Recycling Available

EDGE ASYMMETRIC LINEAR

ORDERING INFORMATION

<input type="text"/>	<input type="text"/>	<input type="text"/>	<input type="text"/>
Series/Type	Power	Size	Mounting
EALN - Edge Asymmetric Linear	I- Integral IEM- Integral EM R- Remote POE- PoE	4- Four Foot 8- Eight Foot	P- Pendant U- Unistrut UC- Unistrut Clip* UCB- Unistrut Clip & Bracket* S- Surface #B- Custom Angle Bracket*

Enter angle for custom angle bracket

<input type="text"/>	<input type="text"/>	<input type="text"/>
Optics	Distribution	Lumen Output
R- Right Facing Asymmetric L- Left Facing Asymmetric	- NA	L#- L40-70 4' Std L75-L95 4' HO* L65-L125 8' Std L130-L140 8' HO*

Refer to Optics reference on page 4

Consult Performance for Lumen Tables with corresponding wattage, and nominal and delivered lumens for SKU.

<input type="text"/>	<input type="text"/>	<input type="text"/>	<input type="text"/>	<input type="text"/>
Adaptive	CCT	CRI	Cord	Cord Color
- NA	27- 2700K 30- 3000K 35- 3500K 40- 4000K 50- 5000K 65- 6500K	80- 80+ CRI 90- 90+ CRI	N- None 3- No Dim 5- Dim 3E- No Dim/EM On 4E- No Dim-EM On/Off 5E- Dim EM On 6E- Dim EM On/Off	N- None W- White B- Black S- Silver Braided

<input type="text"/>	<input type="text"/>	<input type="text"/>	<input type="text"/>
Feed	Finish	End Cap	Sensors*
N- None TFC- Top Center TFE- Top End SF- Side	WPC- White Powder Coat BPC- Black Powder Coat*	WP- White Plastic BP- Black Plastic*	JD- JDRF Autonomy Sensor LU- Lutron Athena Wireless Node WT- Wattstopper FSP-202 LD- LANTANA Dip Switch NL- nLight PIR Sensors CU- Current NX SMP LM- LANTANA Microwave

Refer to Optics reference on page 4 to understand cord placements affect on lighting direction

Sensor sold separately. Sensor purchase includes installation of sensor and sensor end cap. Verify emergency compatibility before ordering. For NL, call for model options

Project: _____ Date: _____
 Part Number: _____ Qty: _____
 Notes: _____

*Additional costs may apply

EDGE ASYMMETRIC LINEAR

PERFORMANCE

IES file Kelvin	4000K
IES file CCT	80CRI
Efficacy	164.17

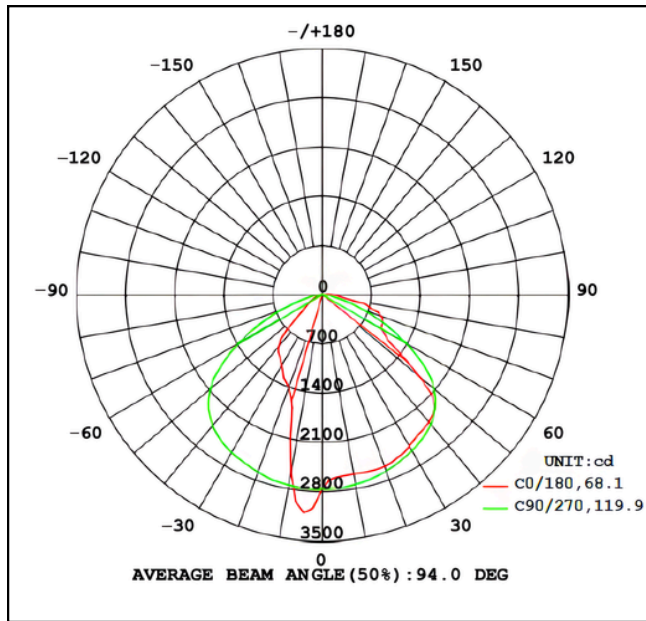

Standard Output				
Size	SKU	Nominal	Watts	Delivered
4'	L40-	4000	24	3940
	L45-	4500	27	4432
	L50-	5000	30	4925
	L55-	5500	33	5417
	L60-	6000	36	5910
	L65-	6500	40	6566
	L70-	7000	42	6895
8'	L75-	7500	45	7387
	L70-	7000	42	6895
	L75-	7500	45	7387
	L80-	8000	48	7880
	L85-	8500	51	8372
	L90-	9000	54	8865
	L95-	9500	57	9357
	L100-	10000	60	9850
	L105-	10500	63	10342
	L110-	11000	67	10999
	L115-	11500	70	11491
	L120-	12000	73	11984
	L125-	12500	76	12476
L130-	13000	80	13133	

CCT (Kelvin)	Multiplier 80 CRI	Efficacy Lm/W	Multiplier 90 CRI	Efficacy Lm/W
2700K	0.91	149.39	0.76	124.77
3000K	0.95	155.96	0.8	131.34
3500K	0.97	159.24	0.82	134.62
4000K	1.00	164.17	0.85	139.54
5000K	1.00	164.17	0.85	139.54
5700K	1.00	164.17	0.85	139.54
6500K	0.99	162.53	0.85	139.54

High Output				
Size	SKU	Nominal	Watts	Delivered
4'	L80-	8000	48	7880
	L85-	8500	51	8372
	L90-	9000	54	8865
	L95-	9500	57	9357
	L100-	10000	60	9850
8'	L135-	13500	82	13461
	L140-	14000	85	13954
	L145-	14500	88	14446
	L150-	15000	91	14939

EDGE ASYMMETRIC LINEAR

DIMENSIONS AND MOUNTING

Edge Asymmetric and Edge Tri-Flat Linears Shown

Integral

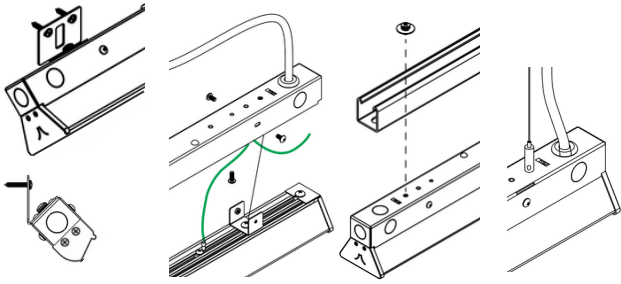

Angle Bracket Surface Unistrut Pendant

Remote

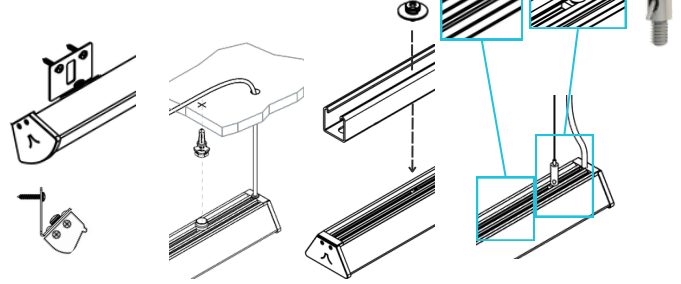

Angle Bracket Surface Unistrut Pendant

Fig 1. Sliding channel nut(s) simplifies adjustment and alignment.
Fig 2. Sliding nut with adjustable grippers for easy leveling.

DIMENSIONS

Integral

FIXTURE SIZE	LENGTH		WIDTH		HEIGHT		WEIGHT	
	IN	MM	IN	MM	IN	MM	LBS	KG
4 ft.	47.1	1196	1.7	43	3.2	81	4.85	2.2
8 ft.	93.2	2367	1.7	43	3.2	81	9.7	4.4

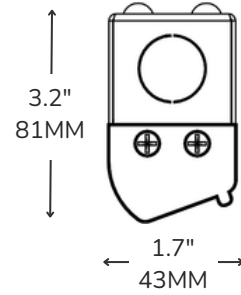

Remote

FIXTURE SIZE	LENGTH		WIDTH		HEIGHT		WEIGHT	
	IN	MM	IN	MM	IN	MM	LBS	KG
4 ft.	47.1	1196	1.7	43	1.8	46	3.85	1.75
8 ft.	93.2	2367	1.7	43	1.8	46	7.7	3.49

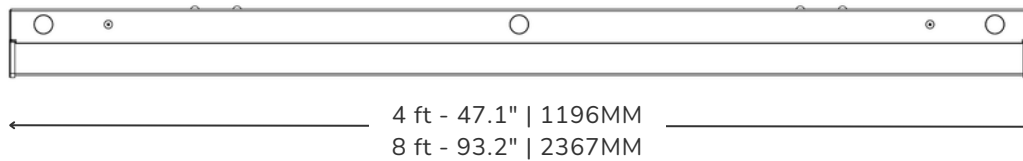
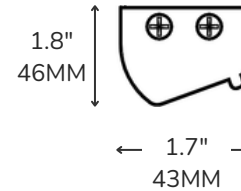

OPTICS

